

2018

FOXCONN OVERVIEW



BUSINESS SOLUTIONS



FINANCIAL INCENTIVES



SITE SELECTION



WORKFORCE DEVELOPMENT

WHY WISCONSIN?

- Strong manufacturing legacy
- A top state to do business with
- Ability to develop skilled workers
 - University of Wisconsin System
 - Wisconsin Technical College System
 - Other educational institutions
- “Can do” attitude
- Geographic location



WHY RACINE COUNTY?

The people: Foxconn executives pointed to Racine County's talented, hardworking workforce.

Leadership: Negotiations led by Racine County, RCEDC, and Mount Pleasant.

Location: Situated in major I-94 corridor between Milwaukee and Chicago.

Available land: Local leaders proactively obtained options from landowners.



FOXCONN

BACKGROUND INFORMATION

- Foxconn generated total annual revenue of \$135 billion and net income of \$4.5 billion in 2016 and was ranked No. 27 on the 2017 Fortune magazine Global 500
 - Fourth-largest technology company in the world
- Foxconn specializes in design, manufacturing and assembly of global computer and high-tech consumer electronics products
- The company has facilities in Asia, Brazil, Europe and Mexico. The Wisconsin facility will be its first significant investment in the U.S.

ABOUT THE PROJECT

- Largest economic development project in Wisconsin history
- 13,000 jobs when campus is complete
 - (avg. salary: \$53,000, plus benefits)
- 10,000 direct construction jobs annually over 4-6 years
- \$10 billion investment
- 18:1 return on investment

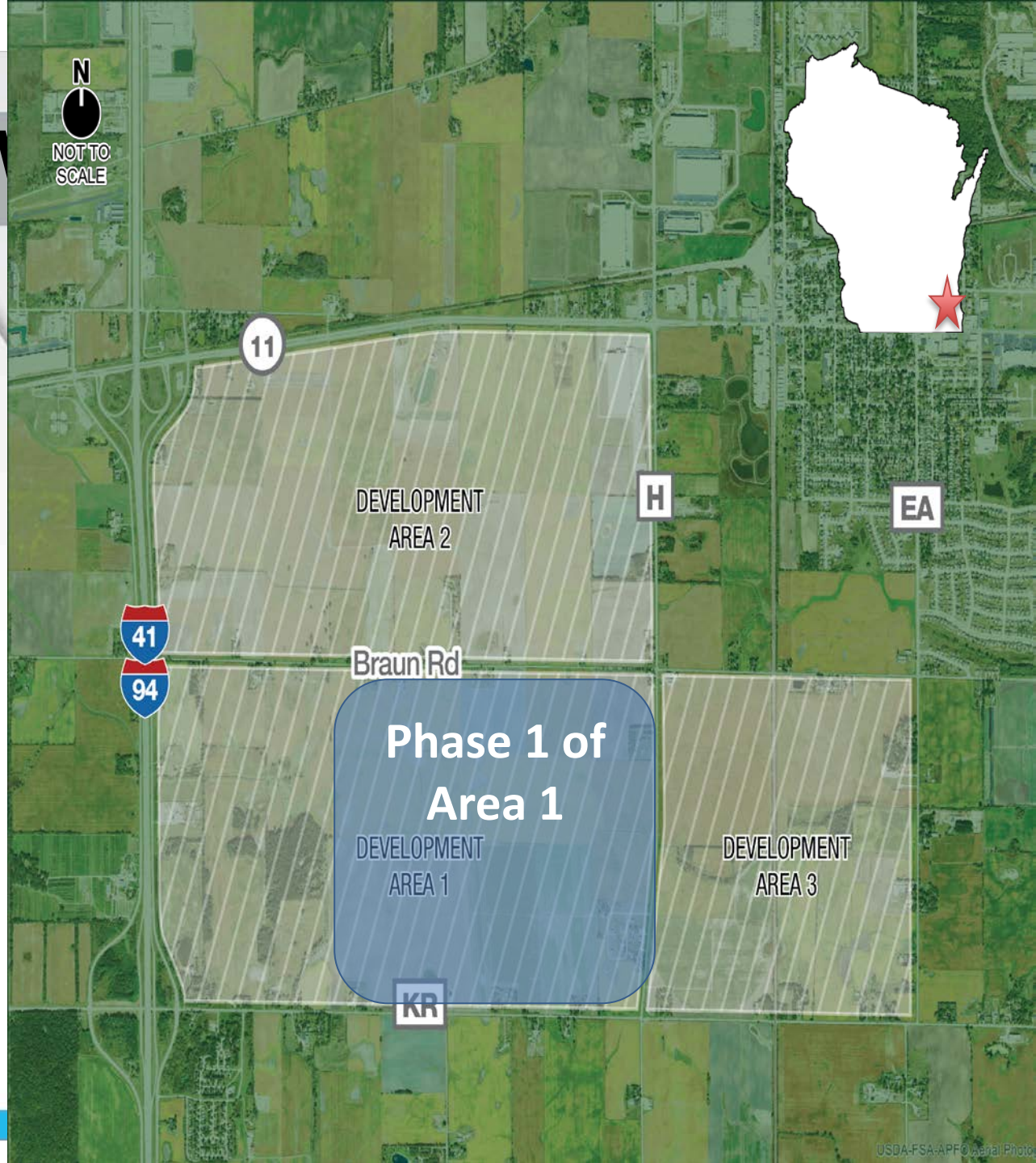

WHAT WILL FOXCONN PRODUCE IN WISCONSIN?

8K + 5G Ecosystem



Advanced Display
for Auto, Medical, TV

Applications
+ Solutions



- Autonomous Cars
- Avionics

- Healthcare
- Smart Factory

- Security
- Entertainment

- Education

Advanced Manufacturing Foundation

- Industrial Internet
- Precision Machining
- Tool & Die



- CAD/CAM
- Robotics & Automation



CONSTRUCTION UNDERWAY

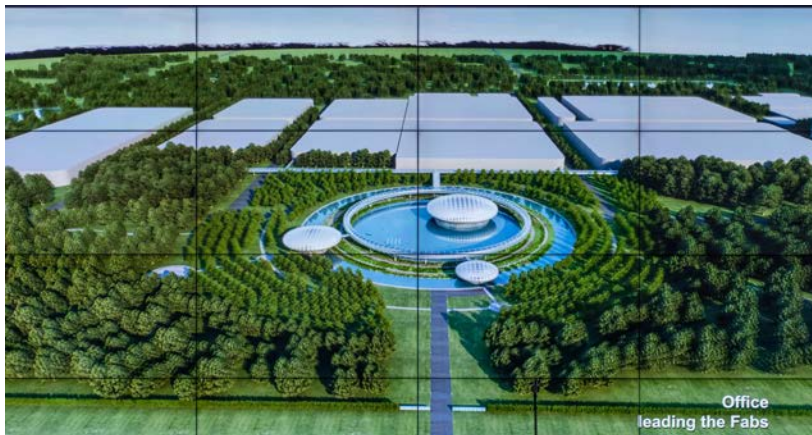

- July 26, 2017: Foxconn Chooses Wisconsin
- October 4, 2017: Mount Pleasant Announced as site of Wisconn Valley Science & Technology Park
- April 26, 2018: Site Work Begins
- August 28, 2018: Ground Breaking Ceremony
- September 4, 2018: Vertical Construction Begins on Multi-Purpose Building
- Q1/Q2 2019 Additional Buildings Begin in Phase 1, Area 1
- Phase 1 buildings Online in 2022

INFRASTRUCTURE



DOT:
I-94 and Local Roadwork

Mount Pleasant:
Sewer Main Construction

City of Racine:
Water Main Construction

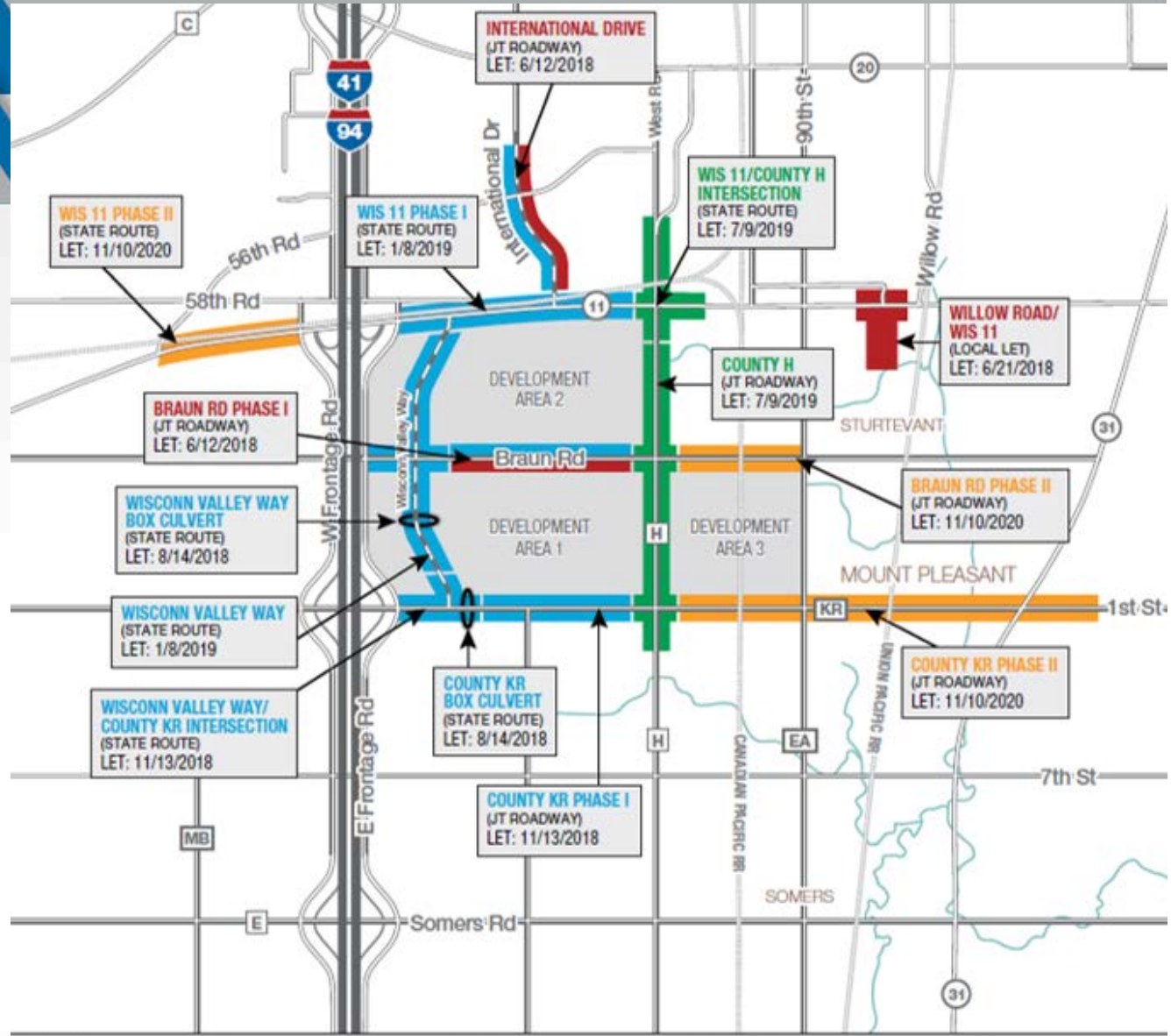

Foxconn Place Racine and the Wisconn Valley Innovation Center

- Location: 1 Main Street, Racine
- Center of Smart City Innovation
- State of the Art Co-Working Space



FOXCONN IS HERE

Now What?

RACINE COUNTY ALREADY REALIZING POSITIVE IMPACTS

- City of Racine had the **largest unemployment decrease** in the state from July 2017 to July 2018
- **Exceeding 10% employment goals** for Racine County workers with construction contracts
- **Property values** in Racine County are on the rise
- **Developers investing** in Racine County
- **Gateway Technical College** is expanding opportunities for students

LOCAL EFFORTS

Goals:

- Maximize Benefits to Racine County Residents and Communities.
- Facilitate Business Growth of Existing Racine County Companies

Planning

Local Talent
Pipeline

Talent
Recruitment

Business
Resources

Racine County Targeted Development Study

- Review existing conditions affecting development in Racine County
- Identify opportunity areas for development.
- Housing identified as a priority.
- Phase 1: State of the Area Report available at www.rcedc.org
- Phase 2: Refine Targets and Impact Analysis



Workforce Analysis

- Led by ManPower Group
- Analyze current and future workforce supply and demand across industries in Racine County.
- Will be used to position Racine County as a top talent destination and build the talent pipeline.



TALENT PIPELINE

- Locally Focused
- Led by Racine County, Gateway Technical College
 - Engages Existing Businesses and Leverages Community Partners
- Uplift 900 (Racine County):
 - Engages un/under employed
 - GreaterRacineAtWork.com
- Training (Gateway, Racine County, and City of Racine)
 - Needed skills by Existing Employers and for Construction
 - Resources from WI Fast Forward



Greater Racine County

where your future takes root



Quality of Life



Communities



Education



Jobs

www.GreaterRacineCounty.com

- Target: Talent Relocating to SE Wisconsin
- Benefits: Existing Employers and Individuals/Families Relocating
- Tells the Story of Racine County Communities and Employers
- Phase I: Website and Job Board, October 2018
- Phase II: Marketing Campaign Linked to WEDC Efforts



City Life



Suburban Living



Rural Retreats



On the Water

Greater Racine County Loan Fund: Assist existing businesses in Racine County affected by Foxconn and companies new to Racine County. Flexible Loan Terms. Loan amounts between \$50,000 to \$250,000. www.blp504.org

Racine County Matching Grant: Assist small and medium sized companies obtain professional services to support business growth. Uses: Consulting, training, marketing, and leadership training costs. 50% grant of up to \$5,000 per company. Application available at RCEDC.org

Cross-Cultural Training: October 18, 8 am-noon at iMET Center. Presented by the U.S. Chinese Chamber of Commerce. Register at RCEDC.org

Leadership Series: 12-month Open Enrollment Series focused on developing leadership skills of managers. Facilitated by Living As A Leader. Starts April 2019 at the Sealed Air YMCA. More information at RCEDC.org

Local Foxconn Information:

- www.FoxconnRacineCounty.com
- <http://www.mtpleasantwi.gov>
- Monthly Project Updates: 3rd Monday at 6 pm, Mount Pleasant Village Hall

Wisconn Valley Updates:

- Wisconnvalley.wi.gov
- www.wisupplychainmarketplace.com

Resources:

- RCEDC.org
- www.GreaterRacineCounty.com
- GreaterRacineatWork.com



We Are Your First Point of Contact to Secure a Location In Racine County

Jenny Trick
Executive Director
262-898-7424
jtrick@rcedc.org

Laura Million
Business Development Manager
262-898-7530
lmillion@rcedc.org

Carolyn Engel
Business Finance Manager
262-898-7420
carolyn@blp504.org